

# LIGHTFIELD

HIGH ST. BARNET. LONDON

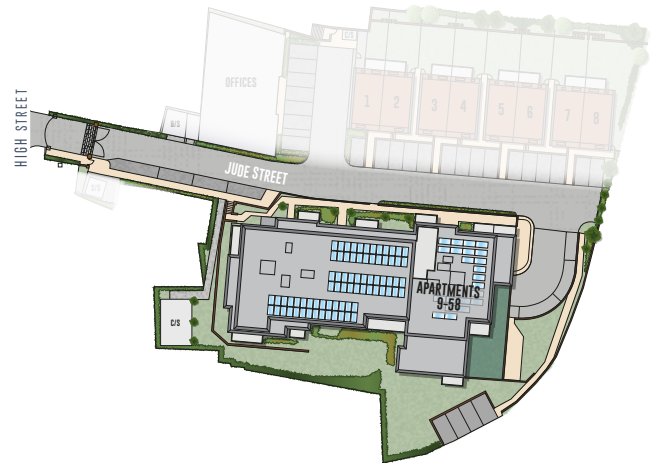

This site plan is a guide for illustrative purposes only. Landscaping shown is indicative only.

## APARTMENT 12 ONE BEDROOM

Enjoy a desirable lifestyle in this contemporary, ground floor, one-bedroom apartment. Enter via the hallway, featuring ample storage space and leading into the welcoming kitchen/living/dining area. This modern, open-plan room is the perfect central hub of the home, with a French door expanding the living space even further onto the patio area. The kitchen features sleek, high-specification, integrated appliances.

The double bedroom enjoys the added luxury of fitted wardrobes with a large bathroom just next door. Your new home at Lightfield offers all the benefits of a lush green suburb, while being just 30 minutes from the Capital.



### Kitchen/Living/Dining Area

7.30m x 3.40m      24'0" x 11'2"

### Bedroom

3.80m x 3.10m      11'8" x 10'2"

### Total area

48.4 sq. mts.      521.00 sq. ft.

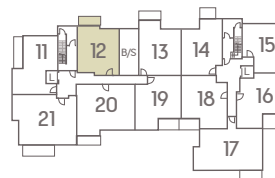

GROUND FLOOR

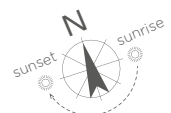

For more information please call 01494 685825 or [shanlypartnership.com](http://shanlypartnership.com)

◀ Point from which maximum dimensions are measured. Dimensions are intended for guidance only and may vary by plus or minus 7.6cm/3". The plots indicate general layout only which may vary from other plots. Kitchen and bathroom layouts indicative only.

W denotes wardrobe. S denotes storage. L denotes lift. B Boiler.

Please contact sales consultant for more information.

**SHANLY**  
**PARTNERSHIP**  
**HOMES**